

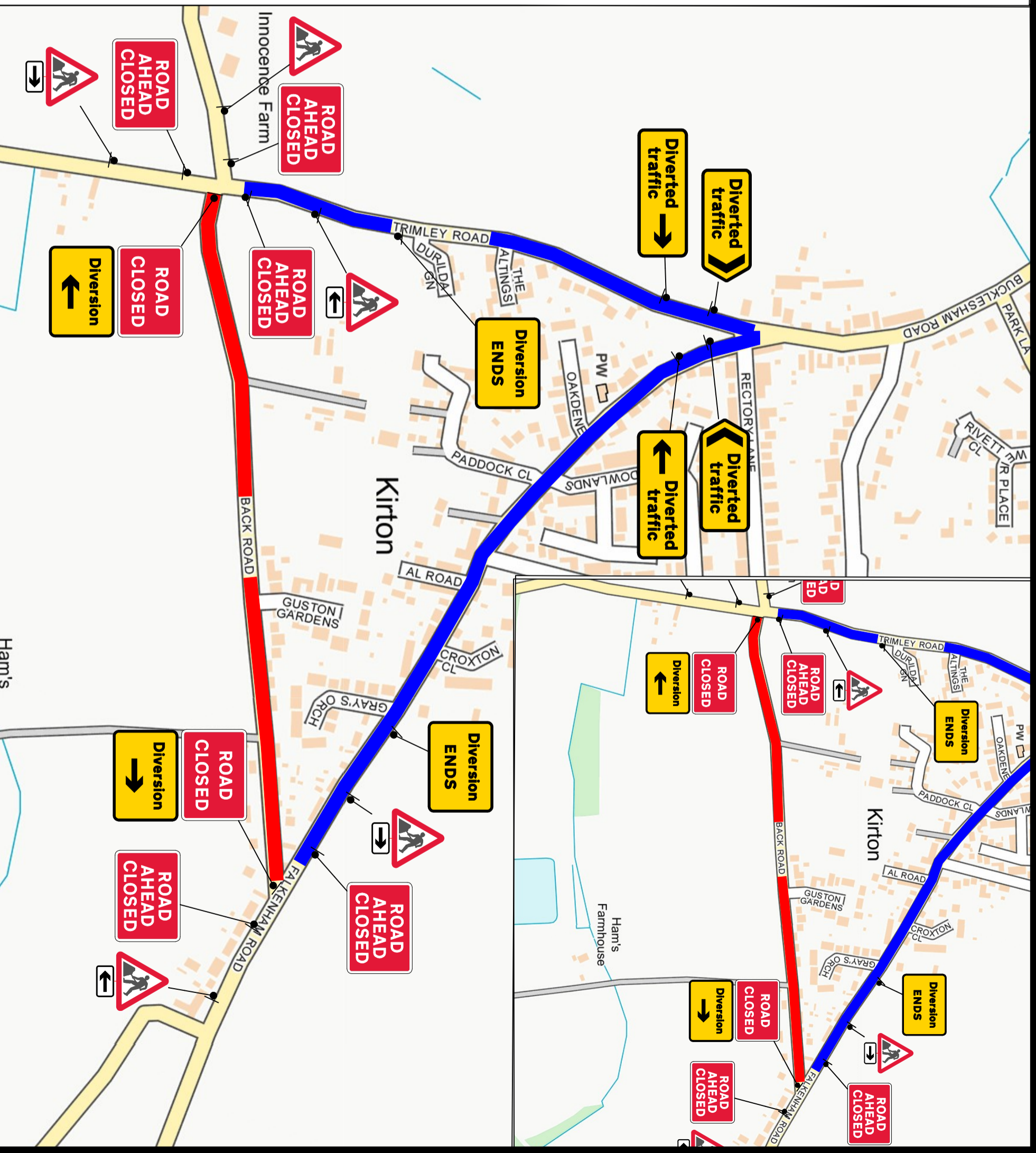

Road Closure —

Diversion —

QTY: 2 Ref: 2702 End of temporary diversion route	
QTY: 1 Ref: 2702 Start of temporary diversion route	
QTY: 1 Ref: 2702 Start of temporary diversion route	
QTY: 1 Ref: 2703 Direction of temporary diversion route from junction ahead	
QTY: 1 Ref: 2703 Direction of temporary diversion route from junction ahead	
QTY: 1 Ref: 2703 Direction of temporary diversion route from junction ahead	
QTY: 1 Ref: 2703 Direction of temporary diversion route from junction ahead	
QTY: 1 Ref: 2704 Direction of temporary diversion route	
QTY: 1 Ref: 2704 Direction of temporary diversion route	
QTY: 1 Ref: 2704 Direction of temporary diversion route	
QTY: 1 Ref: 2704 Direction of temporary diversion route	
QTY: 2 Ref: 573 Direction to hazard left	
QTY: 2 Ref: 573 Direction to hazard right	
QTY: 5 Ref: 7001 Road works ahead	
QTY: 5 Ref: 7010-PP-139 Nature of temporary hazard ahead - Road Ahead Closed	
QTY: 2 Ref: 7010-PP-139 Nature of temporary hazard ahead - Road Closed	



**Notes**

All dimensions are in metres unless otherwise stated.  
 TM to comply with Traffic Signs Manual, Chapter 8. All  
 traffic management designs must be checked by a  
 suitably qualified person, as part of the design process.

OCU Opals

01733788878

ocugroup.com/ocu-opals/

Clint Ref : STM 1748

Drawing No 0001

Original drawing size A3 - NTS