

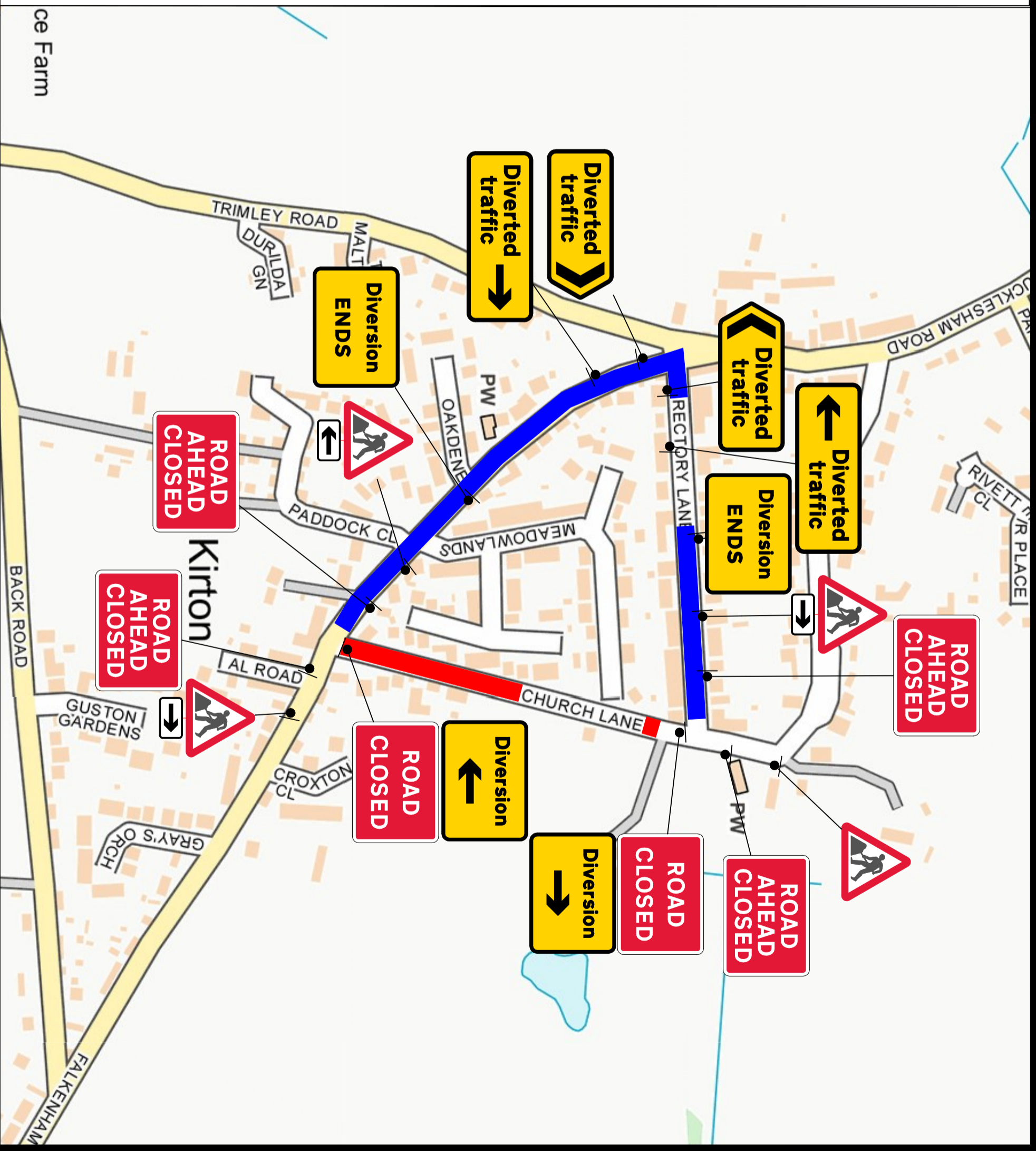

Road Closure —

Diversion —

QV/ 1 Ref: 2702 Start of temporary diversion route	
QV/ 2 Ref: 2702 End of temporary diversion route	
QV/ 1 Ref: 2702 Start of temporary diversion route	
QV/ 1 Ref: 2703 Direction of temporary diversion route from junction ahead	
QV/ 1 Ref: 2704 Direction of temporary diversion route	
QV/ 1 Ref: 2704 Direction of temporary diversion route	
QV/ 1 Ref: 573 Direction to hazard left	
QV/ 2 Ref: 573 Direction to hazard right	
QV/ 4 Ref: 7010-FP-139 Nature of temporary hazard ahead - Road Ahead Closed	
QV/ 2 Ref: 7010-FP-139 Nature of temporary hazard ahead - Road Ahead Closed	
QV/ 2 Ref: 7010-FP-139 Nature of temporary hazard ahead - Road Ahead Closed	



**Notes**

All dimensions are in metres unless otherwise stated.  
 TM to comply with Traffic Signs Manual, Chapter 8. All  
 traffic management designs must be checked by a  
 suitably qualified person, as part of the design process.



OCU Opals  
 017333788878  
 ocugroup.com/ocu-opals/

Site Address: Church Lane, Kirton, IP10 0PT

Clint Ref : STM 1737  
 Drawing No 0001  
 Original drawing size A3 - NTS